

GL450 GALVANISED STEEL GUYED LATTICE TOWER

AP-GLT-GL450 GUYED TOWER, GROUND MOUNTED

OVERVIEW

APAC's modular guyed galvanised steel lattice towers are manufactured locally in Queensland in 6.3 metre sections, permitting comfortable handling during transport and assembly. The GL450 module is a stackable triangular design, to build towers up to 63.45 metres when guyed (10 sections). Unique to APAC GL series, the tower's 20 mm internal webbing is pressed from a single length of 20 mm steel reo, achieving a number of manufacturing efficiencies while maintaining a high degree of structural integrity. The series' 450 mm face width provides excellent shear and torsional stiffness, necessary for many telecom applications such as microwave and mmWave transmitters. Fully welded and press galvanised steel construction ensures the system can still be delivered at a very low price point, but with minimal maintenance over its working life of 25 years - providing a superior total-cost-of-ownership.

GL450 (Galvanised-Laser, 450 mm face width) towers are a triangle-based (three-leg) self-supporting design, selected for its low production cost, short leadtime, and maximum durability in the extreme weather conditions our country faces. The tower can be manufactured in a galvanised finish, or supplied painted in aircraft colouring, or high visibility for mining applications.

GL450 is a hard-wearing tower system designed for economy and survivability. With a low deflection design, the tower can support heavy loading of ancillaries and supports two simultaneous climbers.

FEATURES

- Rigid stackable design
- 6.75 to 63.45 m tower heights
- 450 mm wide body
- 6300 mm modular lengths
- 60.3 x 4.5 mm Gr250L Steel CHS legs
- N20 mm steel reo lattice structure
- Hot-dip galvanised to AS/NZS 4680

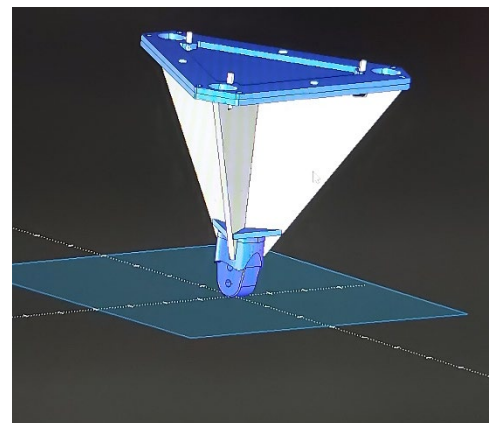
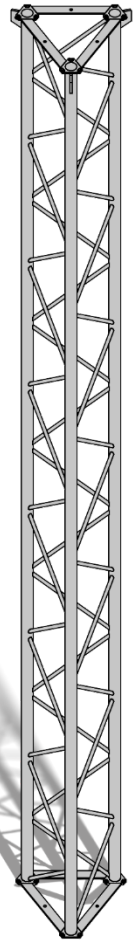

*Machined billet steel
Universal Hinging Base*

SPECIFICATION

PARAMETER	AP-GLT-GL450
Maximum Height	63.45 m (Wind Region B)
Typical Footprint (60° guying)	$diameter = \frac{2h}{\tan 60}$
Wind Survivability	See table below
Max. Lattice Modules	10
Module Length	6300 mm
Module Face Width	450 mm
Module Material	60.3 x 4.5 Gr250L CHS, N20 Reinforcement Bar Web Members
Module Finish	Hot-dip galvanised to AS/NZS 4680
Module Weight	189 kg
Footing	Options available
Guy Kit	Supplied, Galvanised Steel or Stainless Steel options
Guy Wires	8 mm, Class 7x19, Grade 2070, Galvanised Steel
Universal Base Construction	Machined Billet, 12 mm Web & Stiffener Plates
Universal Base Finish	Hot-dip galvanised to AS/NZS 4680

ENGINEERING CERTIFICATION	Wind Region B	Wind Region C
Max. Height (m)	63.45	50.85
No. Modules	10	8

